

# abitana

Home Networks



**TV, Phone, PC, Internet, Music,...**

**Anytime....**

**Anywhere.**



Are you planning to build or renovate a home? Then you'll be wondering where to put the TV, PC or phone sockets, exactly which type of connection you need and how many you require. You will probably even want to have the option to connect a TV, PC and phone in each room. With abitana's Home Network, this is standard practice, and all with one universal connector type. Gone are the days of drilling and dust because of a "forgotten" connection!

We have developed a system that allows you to connect TV, Hi Fi, phone, fax, as well as PC, printer, video recorder, DVD player, cameras etc. to the Home Network via the same type of wall outlet. Better still, all outlets can be interconnected through the central communications cabinet, creating a whole multimedia network. All connected PCs can exchange files or share the fast Internet access line and you can watch a surveillance camera or a movie on the DVD player from any TV set in the house. You will come up with endless network combinations.

## abitana's Home Network – The flexible solution



### **100% flexibility**

Without impairment to the signal quality, each connection point can be used indiscriminately for phone, PC and Radio or TV. You decide for yourself in the central cabinet which equipment to connect.

### **Nice and easy**

No more aggravation because of messy cables and interface boxes lying about. The high-tech cable is concealed inside the walls, panelling, cable ducts or flooring. They are routed towards the central communications cabinet that distributes TV, phone, PC LAN and Internet. Short patch cords are used to link your new equipment to the Home Network's central service modules.

### **Accommodates changing needs**

Rooms can easily be reassigned another task. With an abitana Home Network, adding or moving an electronic appliance is a piece of cake. The primary use of a room is bound to change as the family evolves: children's room becomes student's room or hobby room, maybe you fancy a TV set in the kitchen.

### **Thinking ahead**

The abitana Home Network is future proof. You can interconnect the latest high-tech devices. Even the capability to support Gigabit Ethernet is a standard feature.

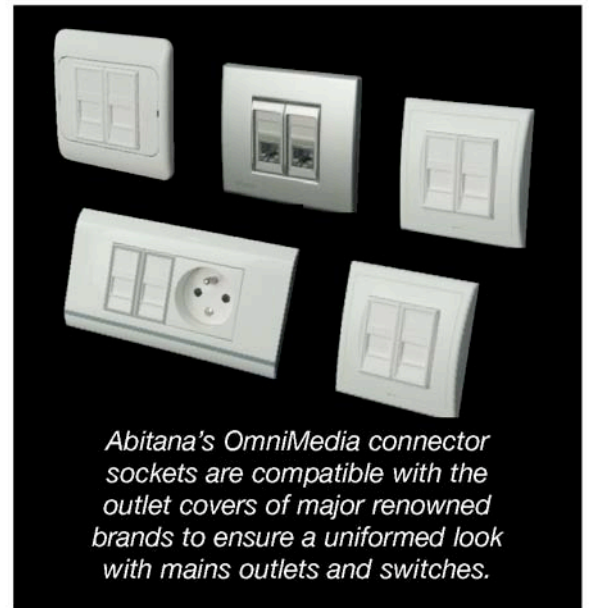

*Abitana's OmniMedia connector sockets are compatible with the outlet covers of major renowned brands to ensure a uniformed look with mains outlets and switches.*

### How does it work?

In each room universal communication sockets are planned. After electricity from the socket, water from the tap and central heating, Home Network is the last missing link in comfort. Each wall socket has a companion connector in the central communications cabinet. Services like terrestrial TV, phone, PC network and music are grouped on central service modules. You will make a connection to bring the service to the right socket in a room by means of a patch cable that goes between the specific connector and the central service module that is providing the required service: TV, phone, PC or music. Modifying the function of a wall socket is simply done by reconnecting the corresponding connector in the communication center to a different service module.



*The central communications cabinet is barely 15cm deep and can easily be accommodated near to the fuse box location or in a utility room.*



### What can I connect?

- Phone, fax, doorphone, videophone,...
- TV, Home Theater, DVD, HiFi, music distribution, MP3-player,...
- PC, printer, scanner, games console,...
- Internet fridge, web tablet, Internet radio,....
- Video surveillance, remote diagnostics,...
- Remote controlled heating, aircon, lighting,...

# A Home Network for modest and exceptional requirements

Choosing the wrong type of connection is a thing of the past with an abitana Home Network. But how many outlets do you need to plan today to satisfy your present-day desires and at the same time cope with your future demands for more comfort?

Let's roam through the various rooms of a traditional house. Each household's living scenario is different, probably not all the mentioned rooms are relevant for your project. You are obviously free to choose more or less outlets to cater for your requirements.



.....

*Services from providers are distributed throughout the home by the service modules in the central communications cabinet. But you can also implement multi-room audio and video distribution with images and sounds from local sources within the home, like surveillance cameras, VCR, DVD player, SAT decoder, HiFi system, MP3 player or music from the PC.*

.....>



.....

*The equipment is connected to the Home Network at the nearest OmniMedia wall socket. In the central communications cabinet the signal is distributed to all TV sets in the home or to the audio equipment in other rooms. The infrared return channel allows control of any device in another room from any room in the house.*

.....>



.....

*Additions, moves and changes are a piece of cake by the modular approach of the central communications cabinet.*

.....>



## Attic/Hobby room

Attics are often not suitably equipped at the building stage, but are turned into a hobby room, extra bedroom or home office at a later stage. Do not forget to install two sockets for each of these areas.

*A little camera connected to the Home Network allows you to watch playing children or check who is entering the driveway.*

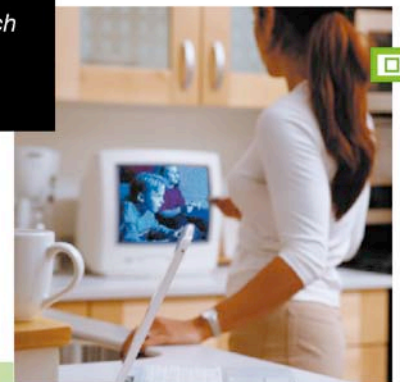

## Kitchen

The kitchen is the most social place of the house, often it serves as work area, school tasks are brought to the kitchen table, phone and TV are high on the wish list of this family spot. We recommend four sockets.

The TV set in the living room, the children's room and the home theater can view at the same time, or each individually, the programs that are available on the TV distribution network, the Sat receiver, the video recorder or the DVD player.



### Living room

Many living rooms have a separate leisure and dining area, often there is a corner that serves as work desk. TV and radio are essential, a connection to the phone network and the Internet are recommended. Four to six sockets are a minimum provision for the living room.

Listening in the lounge to MP3 music that is stored on a PC based in the study, adding a pair of speakers in the kitchen, enliven the barbecue by summer music on the terrace, ... a five-minute job with the audio module.

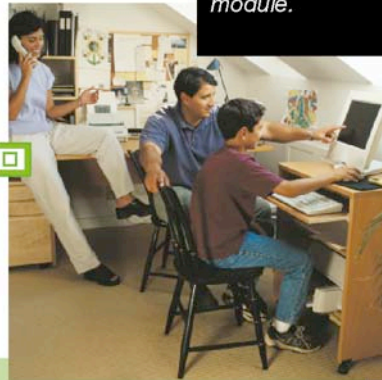

### Home Office

Four connections are an absolute minimum for phone, fax, PC, printer etc.

### Bedrooms

It is safe to plan four sockets in each bedroom. Adolescents often require their own phone, PC and TV set and then when they leave home, their room can easily be converted to a home office or a hobby room.

Children have their own PC, through the home network they can surf the web and use the printer and scanner of the home office as well.



### Bathroom

Watch TV or listen to your favorite music while you are relaxing in the bath? No longer just a dream!

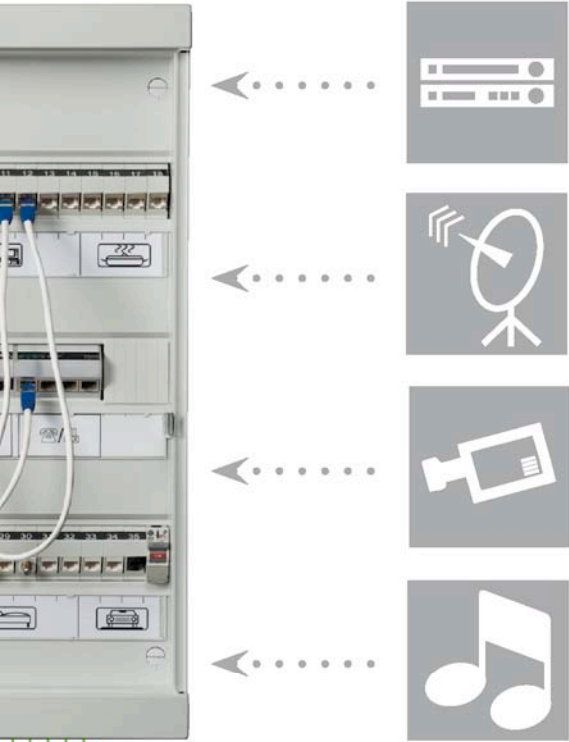
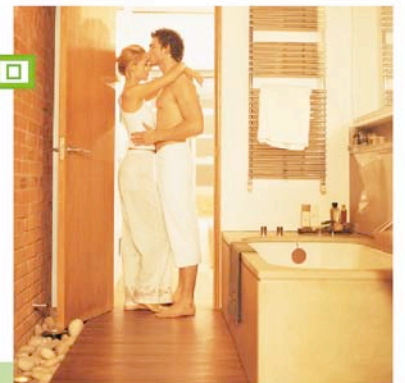

# Main components of an abitana Home Network

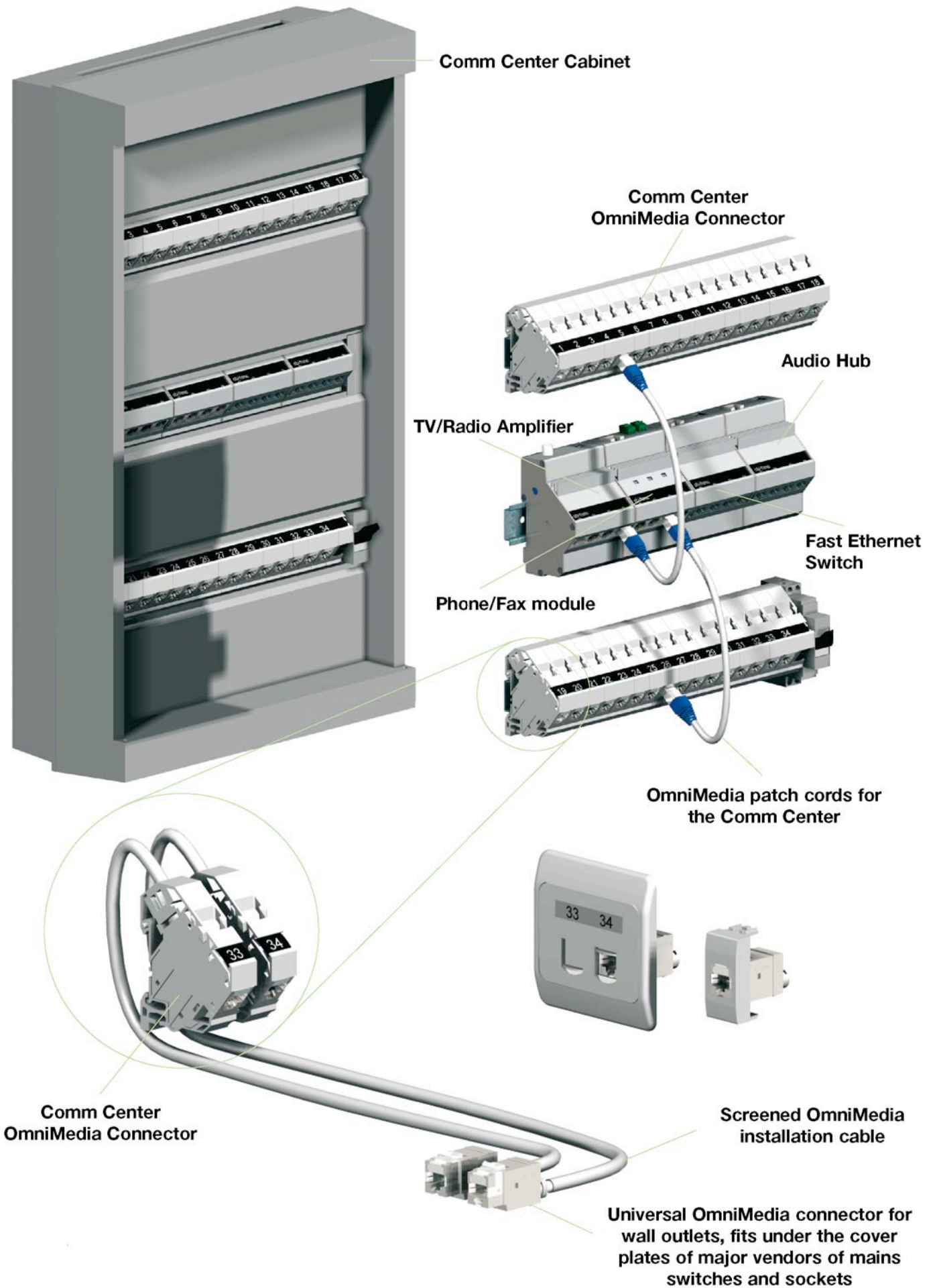

	<p><b>Comm Center</b> The Comm Center is a standard wall mount or flush mount DIN rail cabinet, available in many sizes and finishes. Clear labels and icons make it extra user friendly. Adding new functions is easy because of the modular approach. It is important to foresee this by planning in some spare space when choosing the right cabinet.</p>
	<p><b>Comm Center connector</b> Each OmniMedia wall outlet has a corresponding connector in the Comm Center. They are interconnected by OmniMedia installation cable. The Comm Center connector takes up one standard DIN rail width (17,8mm). This ensures total freedom when dimensioning the home network. The Comm Center connector is built up from a holder that snaps onto the rail and the connector itself that clicks into the holder after termination to the cable.</p>
	<p><b>TV/Radio Amplifier</b> This amplifier module distributes TV and FM radio to four locations in the house. It features a variable gain for optimum picture quality. The module is available with abitana's IR-bus, a return channel for the infrared remote controls of the DVD player, video recorder, satellite decoder etc.</p>
	<p><b>Audio/Video Modulator</b> Images and sound delivered by up to 4 sources such as a VCR, DVD player, SAT receiver or surveillance camera can be viewed on any of the TV sets that are connected to the Home Network. The module is equipped with abitana's IR-bus.</p>
	<p><b>IR-Bus</b> Abitana's IR-bus features an infrared detector at the side of the TV set and an infrared transmitter at the side of the DVD player, VCR, SAT decoder, etc. IR receiver and transmitter are interconnected through the Home Network cabling and eventually the TV/Radio module and the Audio/Video modulator. This enables any equipment to be remote controlled from any room of the house.</p>
	<p><b>Phone/Fax module</b> Sends phone lines to four wall outlets and interconnects phone and fax equipment that may be located in different rooms. Suitable for one or two analog incoming lines or an ISDN line. A version supporting the call confidentiality function is also available.</p>
	<p><b>Fast Ethernet Switch</b> This 5 port 10/100 Mbps Switch allows to connect up to 5 network devices such as PCs, printer, scanner,... in a local network. The Fast Ethernet Switch automatically recognizes all connected PCs and selects the highest possible port speed (10 or 100Mbps), the port polarity (MDI/MDIX) and the transmission mode supported by each piece of equipment. When connected to a modem/router, every PC can simultaneously use the same broadband internet access line.</p>
	<p><b>Audio Hub</b> The Audio Hub is placed in the central communications cabinet and allows the distribution of line level signals between mono or stereo audio sources (like tuner, CD player, tape recorder, PC audio board outputs,...) and playback or recording equipment (like amplifiers, active speakers, tape recorders, hard disk recorders, PC audio board inputs, ...). The hub allows listening to 2 independent stereo sources in 5 zones of the house. Each audio connection can take care of two stereo signals, in the same direction (two stereo upstream signals) or in opposite directions (one stereo upstream, one stereo downstream). Infrared remote control signals can be fed from each "listening" side to each audio source via cabling and Audio Hub.</p>
	<p><b>OmniMedia patch cords</b> Shielded OmniMedia patch cords make the interconnections inside the Comm Center.</p>
	<p><b>Adapters</b> Various adapters are available to connect all types of equipment to the Home Network using standard connection cords.</p>
	<p><b>OmniMedia connectors</b> The abitana OmniMedia connector is the engine of the Home Network. Indiscriminately of the application, an RJ45 connector with a high shielding efficiency is used. The connector snaps into the outlet cover plates of your choice by a simple click-latch mechanism. Standard color coding and fork-type IDC contacts ensure a quick and reliable installation onto the OmniMedia cable.</p>
	<p><b>Screened OmniMedia installation cable</b> This very high-frequency installation cable takes care of interconnecting the OmniMedia wall outlet and the OmniMedia Comm Center connector. This cable is suited for wideband applications up to 865 MHz and all types of signals that will be encountered in the challenging multimedia home network. The screened OmniMedia cable has four twisted pairs, of which one has been optimized to transport wideband TV signals. The four pairs together enable very high speed PC networking up to 1000Mbps (Gigabit Ethernet).</p>

Such a Home Network sounds interesting some will say, but is probably beyond my means. Think again, an abitana Home Network Solution is within everybody's reach. The installation is straightforward and the use is absolute child's play. The additional cost of an abitana Home Network system is negligible when compared to traditional cabling, and therefore likely to interest everybody.

## Who installs your Home Network?

The abitana Home Network's Comm Center, cable and outlets are preferably installed by your electrical or telecomms contractor. He will label the connectors in the Comm center according to the wall outlet locations to allow easy identification and swift connection of services whenever you add or move a piece of equipment in the home.

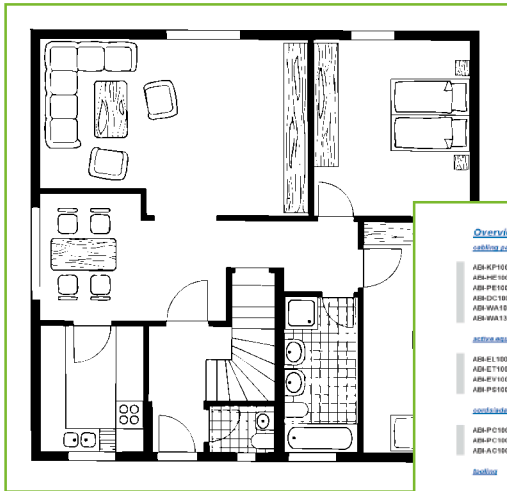

Your plans

[Overview pricequotation](#)

cabling part	quantity	price
AB-KP1001000	400	
AB-ME1001500	1	
AB-PE1002000	1	
AB-DC1002000	26	
AB-WA1001000	13	
AB-WA1002000	26	

[active equipment](#)

AB-EL1002000	1	
AB-ET1002000	1	
AB-EV1002000	1	
AB-PT1001000	1	

[cabling materials](#)

AB-PC1002045	3	
AB-PC1002060	1	
AB-AO1001000	3	

[tools](#)

[other equipment](#)

[installation](#)

subtotal cabling-parts	1 035,91
subtotal active-equipment	570,44
subtotal patch-cables-and-adapters	162,89
subtotal tooling	
other-equipment	
installation-price	
total excl. vat	1 769,24
vat 7%	125,85
total incl. vat	1 895,09

page 3

Your personalised offer

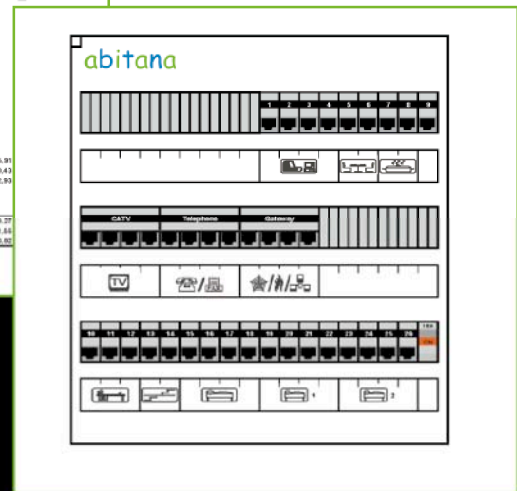

Your central cabinet

## Tell me more?

Our website provides detailed information for the builder, home owner, architect and installer and also examples of popular applications, installation practices, connection diagrams for user equipment, network basics, technical support, product literature etc.

Contact us by phone, fax, e-mail or mail for further information or technical support. If you provide us with your project plans, we'll gladly prepare a number of scenarios and personalized offers.